

THE COAL LOADER

WAVERTON PENINSULA PARKLANDS

Proposed Interpretative Media & Wayfinding Signage

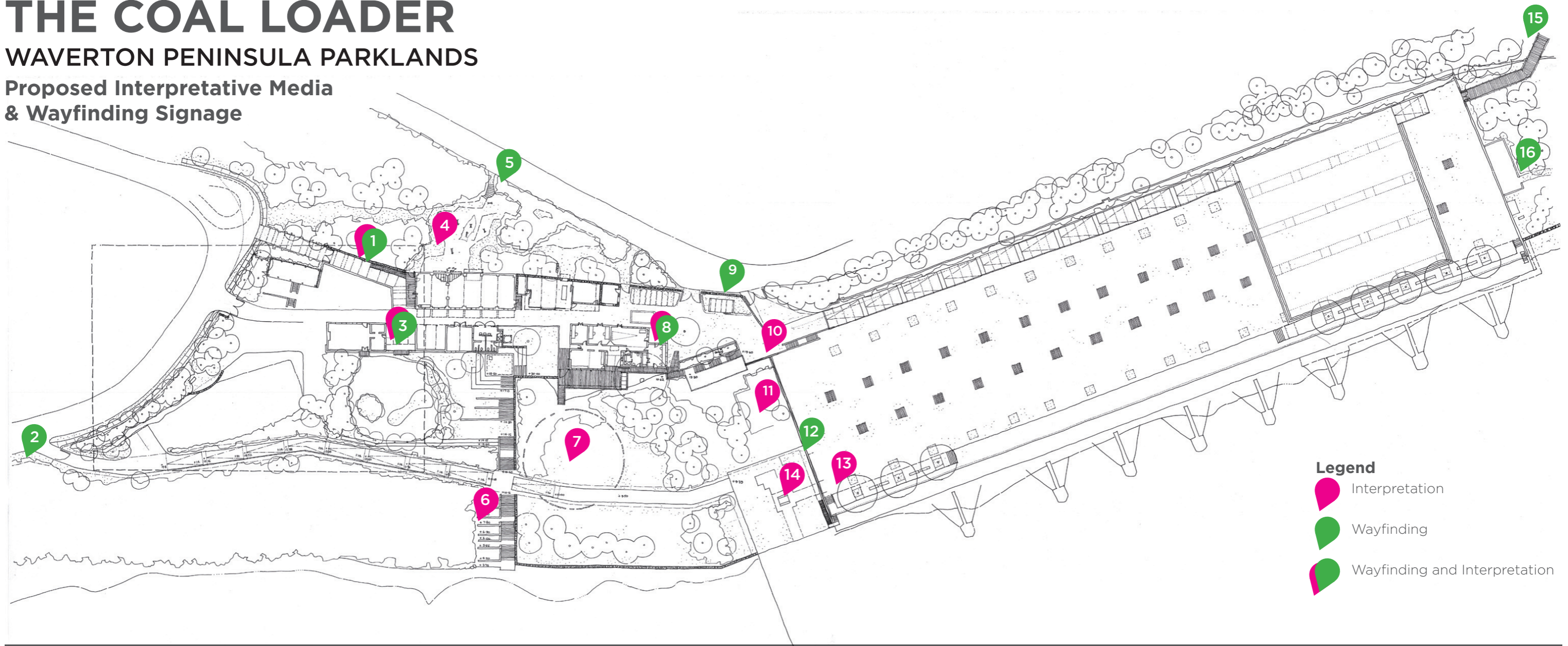

WAYFINDING

1 GATEWAY ENTRY

- The primary identification sign with park name will be visible to approaching vehicular traffic. This will be an integrated element.

2, 5, 9, 12, 15, 16 WAYFINDING

- Secondary pedestrian entrance sign with park name, map and information on the park features and amenities. Shows connection to greater Waverton Parklands.

WAYFINDING & INTERPRETATION

3 INFORMATION KIOSK

- Primary visitor information orientation/meeting place.
- Directional signage with map, key and trail detail.
- Map features pictograms and trail marker symbols that perform as clues on a 'treasure hunt'.
- Meeting place for oral history, starting point for self-guided tour.

10 LOOKOUT

- Key site for directional signage and interpretative media focusing on the site's geography and the 'working harbour'.
- Ground map etched into concrete of the harbour highlighting the changes to the site over time.
- Interpretive panels featuring history of the site.

8 SUSTAINABILITY CENTRE

- A working model of sustainability rather than an exhibition of it.
- Simple map and drawings of the house explain the functionality of the centre.
- Simple unobtrusive markers with pictograms delineate specific sustainable functions of the centre.
- Meeting place for oral history of site.

INTERPRETATION

4 INDIGENOUS WHALE-CARVING STORY

- Adjacent to the whale rock carving is a concrete "doormat" with a scaled-down version of the whale carving. The story of the 'whale' in Dreamtime.
- Suggestive of whale inhabiting harbour.

6 STAIRS/RAMP FROM LAND TO WATER

- Interpretive media featuring marine species, both extinct and existing.
- Ties the threads of indigenous fishing practice/sustainability and seasonal indicators together.
- Conveys the connection of land and water.

7 FORMER OIL TANK

- Interpretive media featuring sustainability theme conveyed in the ground plane within the original tank footprint.
- Metaphor for different approaches to the management of resources.

11 TUNNELS

- Interpretive marker/s or tile on exterior of tunnel wall.
- Marker tells the story of the bat colony.

13 INTERIOR TUNNEL

- Internal shafts partly exposed as peepholes, revealing historic images of the Coal Loader.

14 TROLLEY INTERPRETIVE SPACE

- Interpretive media or marker demonstrates the journey of the coal within greater context of the site.
- Return remnant hopper/carriage to site of operation. Creates a 'strong sense of place'.

TRAIL MARKERS

- There will be a series of trail markers throughout the park announcing historic, environmental and sustainable points of interest in the park to assist in the interpretation of the site. The key details will be mapped out in the Shade House (Information Kiosk).