



AGENDA

A **Meeting** of the **Traffic Committee** will be held on Cammeraygal Land at the Council Chambers, 200 Miller Street, North Sydney at 10:00 AM on Friday 9 May 2025.
The agenda is as follows.

Therese Cole
CHIEF EXECUTIVE OFFICER



North Sydney Council is an Open Government Council. The records of Council are available for public viewing in accordance with this policy, with the only exception being made for certain confidential documents such as legal advice, matters required by legislation not to be divulged, and staff matters.

1. Confirmation of Minutes	3
2. Disclosures of Interest.....	3
3. Matters Arising from the Minutes	3
4. Matters Arising from Council Resolutions.....	3
5. Items for Consideration.....	4
<i>5.1. Out-of-Session Endorsements</i>	<i>4</i>
<i>5.2. West Street, North Sydney - Parking Restriction Change.....</i>	<i>17</i>
6. Informal Items for Consideration.....	25
7. Local Development Advisory Committee Items for Consideration	25
8. Closure	26

1. Confirmation of Minutes

The Minutes of the previous meeting held on the 28 March 2025, copies of which had been previously circulated, were taken as read and confirmed.

2. Disclosures of Interest

Nil.

3. Matters Arising from the Minutes

Nil.

4. Matters Arising from Council Resolutions

Nil.

5. Items for Consideration

5.1. Out-of-Session Endorsements

AUTHOR	Narelle Lamond, Traffic Operations Officer
ENDORSED BY	Gary Parsons, Director Open Space and Infrastructure
ATTACHMENTS	<ol style="list-style-type: none">1. 5 1 Attach Out of Session Endorsements [5.1.1 - 4 pages]2. ATTACHMENTS [5.1.2 - 1 page]3. 1. Balls Head Road - TGS [5.1.3 - 1 page]4. 2. Waters Lane - TGS [5.1.4 - 1 page]5. 3. Yeo Street - TGS [5.1.5 - 1 page]6. 4. OSE 25 002 451 Miller Street Cammeray NSW Works Zone Locality Sketch [5.1.6 - 1 page]7. 5. 42 Kareela Road - Plan [5.1.7 - 1 page]8. 6. Spofforth Lane at Florence Lane, Cremorne - Map REV 2 [5.1.8 - 1 page]
CSP LINK	<ol style="list-style-type: none">2. Our Built Infrastructure2.3 Prioritise sustainable and active transport2.4 Efficient traffic mobility and parking

PURPOSE:

The purpose of this report is to advise the Committee of matters approved out-of-session from scheduled Traffic Committee meetings with the concurrence of Transport for NSW, NSW Police, local State Members, and under delegated authority to the Service Unit Manager for Traffic & Transport Operations.

EXECUTIVE SUMMARY:

Items listed within the schedule attached to this report have been approved out of the regular session of Traffic Committee. The items have concurrence of Transport for NSW, the NSW Police, and the local State Members and have been approved by North Sydney Council's Traffic Engineer in accordance with North Sydney Council's Delegations of Authority to staff.

RECOMMENDATION:

1. THAT the information regarding Out of Session endorsements be received.

Consultation Requirements

Community engagement is undertaken in accordance with Council's Community Engagement Protocol. Items considered for out-of-session approvals do not require community consultation to be undertaken by Council.

Financial/Resource Implications

All costs are borne by the proponent. Signage and line marking changes proposed by Council are funded by Council's Local Road Signs Expenditure budget.

**ENDORSED FOR PROJECTS UNDER
OUT OF SESSION ENDORSEMENTS
570th TRAFFIC COMMITTEE – 09 May 2025**

No	Street	Location	Precinct, Ward, Electorate	Issue	Recommendation	Approved	Date of Approval	ECM	Comments
Resident Parking									
NIL									
Temporary Road Closures									
25_020	Balls Head Rd	47 Balls Head Road, Waverton	Waverton, Cammeraygal, North Shore	Temporary Road Closure	<p>THAT the Committee endorses the temporary road closure of Balls Head Road from 18 April 2025, 7am-3pm as per the submitted application and Council's standard road closure conditions. Approval is subject to managed access to all affected properties and the applicant notifying all affected residents/tenants as per Council's standard conditions of approval.</p> <p>THAT the Committee endorses & raises no objection if Council receives an application for an extension or alternative date/s to carry out these works due to inclement weather or operational delays, that application be approved, subject to Police Permit approval.</p>	Y	18.03.2025	10356556	18.04.2025
025_023	Waters Lane	Waters Lane between Grosvenor S Street and Grosvenor Lane Neutral Bay NSW 2089	Brightmore , St Leonards, Willoughby	Temporary Road Closure	<p>THAT the Committee endorses the Temporary Road Closure for Waters Lane between Grosvenor Street and Grosvenor Lane Neutral Bay NSW 2089 from 1 May 2025 to 5 May 2025 7am-5pm (6 Days). The closure facilitates the installation of underground high voltage power conduits required for permanent power supply to substation chamber. The closure is proposed as per the submitted application</p>	Y	02.04.2025	10379135	01.05.2025-07.05.2025

**ENDORSED FOR PROJECTS UNDER
OUT OF SESSION ENDORSEMENTS
570th TRAFFIC COMMITTEE – 09 May 2025**

					and Council's standard road closure conditions. Approval is subject to managed access to all affected properties and the applicant notifying all affected residents/tenants as per Council's standard conditions of approval. THAT the committee endorses & raises no objection if Council receives an application for an extension or alternative date/s to carry out these works due to inclement weather or operational delays, that application be approved, subject to Police Permit approval.				
025_025	Yeo Street	53-55 Yeo Street Cremorne NSW 2090	Neutral, Cammeray gal North Shore	Temporary Road Closure	THAT the Committee endorses the Temporary Road Full Road Closure for Yeo Street Cremorne NSW 2089 from 9am on 16 April 2025 to 3am on 17 April 2025. The closure would take place in accordance with the submitted application and Council's standard road closure conditions. Approval is subject to managed access to all affected properties and the applicant notifying all affected residents/tenants as per Council's standard conditions of approval. THAT the committee endorses & raises no objection if Council receives an application for an extension or alternative date/s to carry out these works due to inclement weather or operational delays, that application be approved, subject to Police Permit approval	Y	15.04.2025	10395543	9pm 16.4.2025 – 3am 17.4.2025
Special Zones									

**ENDORSED FOR PROJECTS UNDER
OUT OF SESSION ENDORSEMENTS
570th TRAFFIC COMMITTEE – 09 May 2025**

25_002	451 Miller Street	451-455 Miller Street Camberay NSW 2062	Camberay, North Shore, Camberaygal	Install Works Zone	<p>THAT the Committee endorse the temporary reallocation of kerb space on the eastern side of Miller Street, Camberay between the points 83 metres and 99 metres (16 metres) north of Amherst Street as “Works Zone 10am-5pm Mon-Fri 8am-1pm Sat” and “Clearway 6am-10am Mon-Fri”</p> <p>The works are proposed for an initial period of 52 weeks to support the development of DA: 248/22.</p>	Y	15.04.2025	10322298	16 metre works zone
Regulatory Signs									
25_018	Kareela Road	42 Kareela Road, Cremorne Point NSW 2090	North Shore, Cremorne Point, Camberaygal	Install Accessible Parking	<p>THAT the Committee endorses the installation of a kerb space on the western side of Kareela Road between the points 41 meters and 47 meters as “Disabled Parking” and between the points 47 meters and 48.8 meters as “No Parking”.</p>	Y	07.03.2025	10348098	
025_024	Spofforth Lane at Florence Lane	Spofforth Lane, Cremorne	Harrison-Bennett, Camberaygal, North Shore	Install No Stopping signs	<p>THAT the Committee endorse the installation of a “No Stopping” restriction as follows:</p> <ul style="list-style-type: none"> On the northern side of Florence Lane at point 10 metres west of Spofforth Lane, On the northern side of Florence Lane at point 10 metres east of Spofforth Lane, On both sides of Spofforth Lane at point 20 metres north of Florence Lane. 	Y	15.04.2025	10391642	

**ENDORSED FOR PROJECTS UNDER
OUT OF SESSION ENDORSEMENTS
570th TRAFFIC COMMITTEE – 09 May 2025**

Signs Across Driveways									
25-019	Middle Street	50 Middle Street McMahons Point NSW 2060	Lavender Bay, McMahons Point, Camberaygal	Install Driveway line markings	THAT the Committee endorses the installation driveway line markings at the entry to 50 Middle Street McMahon's Point NSW 2060 between the points 71.2 metres & 77.1 metres north of Parker Street.	Y	01.04.2025	10379714	
25-021	Crows Nest Road	58 Crows Nest Road, Waverton NSW 2060	Waverton, St Leonards, Willoughby	Install No Parking Signposts	THAT the Committee endorses the installation of No Parking signposts at the entry to 58 Crows Nest Road Waverton NSW 2060 between the points 31.8 metres & 35.6 metres east of Pacific Highway Waverton NSW 2060	Y	02.04.2025	10379721	
25_022	McLaren Street	12 McLaren Street (Located in Church Street) North Sydney NSW 2060	Stanton, Cammeraygal, North Shore	Install Driveway line markings	THAT the Committee endorses the installation of driveway line markings for 12 McLaren Street, with the driveway located on Church Street, North Sydney, NSW 2060, between points 22 metres & 27 metres north of McLaren Street North Sydney NSW 2060	Y	01.04.2025	10379776	
Warning Signs									
Nil									
Construction Management Plan									
Nil									
Australian Road Rules Compliance Signs									
Nil									
Traffic Facilities									
NIL									
Council Decisions									
Nil									

ATTACHMENTS

GENERAL NOTES

- THIS DRAWING IS TO BE READ IN CONJUNCTION WITH AS 1742.3 and TNSW TCAMS Ver 6.1. (2022) and AGTM (2021)
- NON-APPLICABLE EXISTING SIGNAGE SHALL BE COVERED E.G. SPEED SIGNS DUE TO THE TEMPORARY SPEED ZONE.
- ALL SIGNAGE DISTANCE SHALL COMPLY WITH AS 1742.3 and TNSW TCAMS Ver 6.1. (2022)
- IN ACCORDANCE WITH TCAMS Ver 6.1 (2022) TRAFFIC CONTROLLERS TO ASSIST PEDESTRIANS WITH MOVEMENT THROUGH & AROUND THE WORKSITE.
- SIGNAGE SHALL BE PLACED ON THE SIDE OF THE ROAD ADJACENT TO THE TRAFFIC FLOW.
- REMOVAL OF TRAFFIC CONTROL SIGNS AND DEVICES SHOULD BE UNDERTAKEN IN THE REVERSE ORDER OF ERECTION, PROGRESSING FROM THE WORK AREA OUT TOWARD THE APPROACHES.

RECOMMENDED TAPER LENGTH

APPROXIMATE SPEED OF TRAFFIC KMH	TRAFFIC CONTROL AT BEGINNING OF TAPER	LATERAL MERGE TAPER
45 OR LESS	15	0 - 15
46 - 55	15	15 - 30
56 - 65	30	30 - 60
66 - 75	N/A	70 - 115
76 - 85	N/A	80 - 130
86 - 95	N/A	90 - 145
96 - 105	N/A	100 - 160
> 105	N/A	110 - 180

DIMENSION "D" (AS 1742.3)

SPEED OF TRAFFIC KMH	DIMENSION "D" M
45 OR LESS	5m
46 - 55	15m
56 - 65	45m
GREATER THAN 65 KMH	EQUAL TO POSTED SPEED

TOLERANCES

POSITIONING OF SIGNS
MINIMUM 10% LESS THAN THE DISTANCE OR LENGTHS GIVEN
MAXIMUM 25% MORE THAN THE DISTANCE OR LENGTHS GIVEN
SPACING OF DELINEATING DEVICES
MAXIMUM 10% MORE THAN THE SPACING GIVEN
NO MINIMUM

LANE WIDTHS

THE MIN LANE WIDTH TO BE PROVIDED THROUGH OR PAST THE WORKSITE SHALL BE 3.0m (3.5m DESIRABLE)

QUEUE MANAGEMENT PLAN

AT ALL TIMES DURING THE COURSE OF THE WORK TRAFFIC QUEUES SHALL BE MONITORED TO ENSURE THAT TRAFFIC DOES NOT EXCEED BEYOND THE LIMITS OF ADVANCED WARNING SIGNS

VEHICLE MOVEMENT PLAN

ALL WORK VEHICLES TO ENTER AND EXIT WORKSITE UNDER THE DIRECTION OF TRAFFIC CONTROLLER WITH THE TRAFFIC FLOW ON DESIGNATED UHF CHANNEL

LEGEND

- TEMPORARY SIGNAGE CONFORMING TO AS1742.3 & TCAMS V.6.1
- 700MM TRAFFIC CONE WITH REFLECTIVE NIGHT STRIP
- ARROWBOARD
- WORK AREA
- AUTHORISED TRAFFIC CONTROLLER
- TC VEHICLE
- VMS BOARD
- PEDESTRIANS PATH

LOCALITY MAP

The locality map shows the project location at the intersection of Balls Head Rd and Woolcott St, near Waverton Park and Waverton Reserve.

SafeWork NSW

Thays DE SOUZA SAMPAIO
Card No: TCT0072414
Date of Issue: 15/08/2019
Type of traffic control work: IMP TCR PWZ

BORGHER traffic

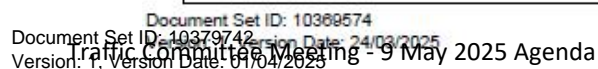

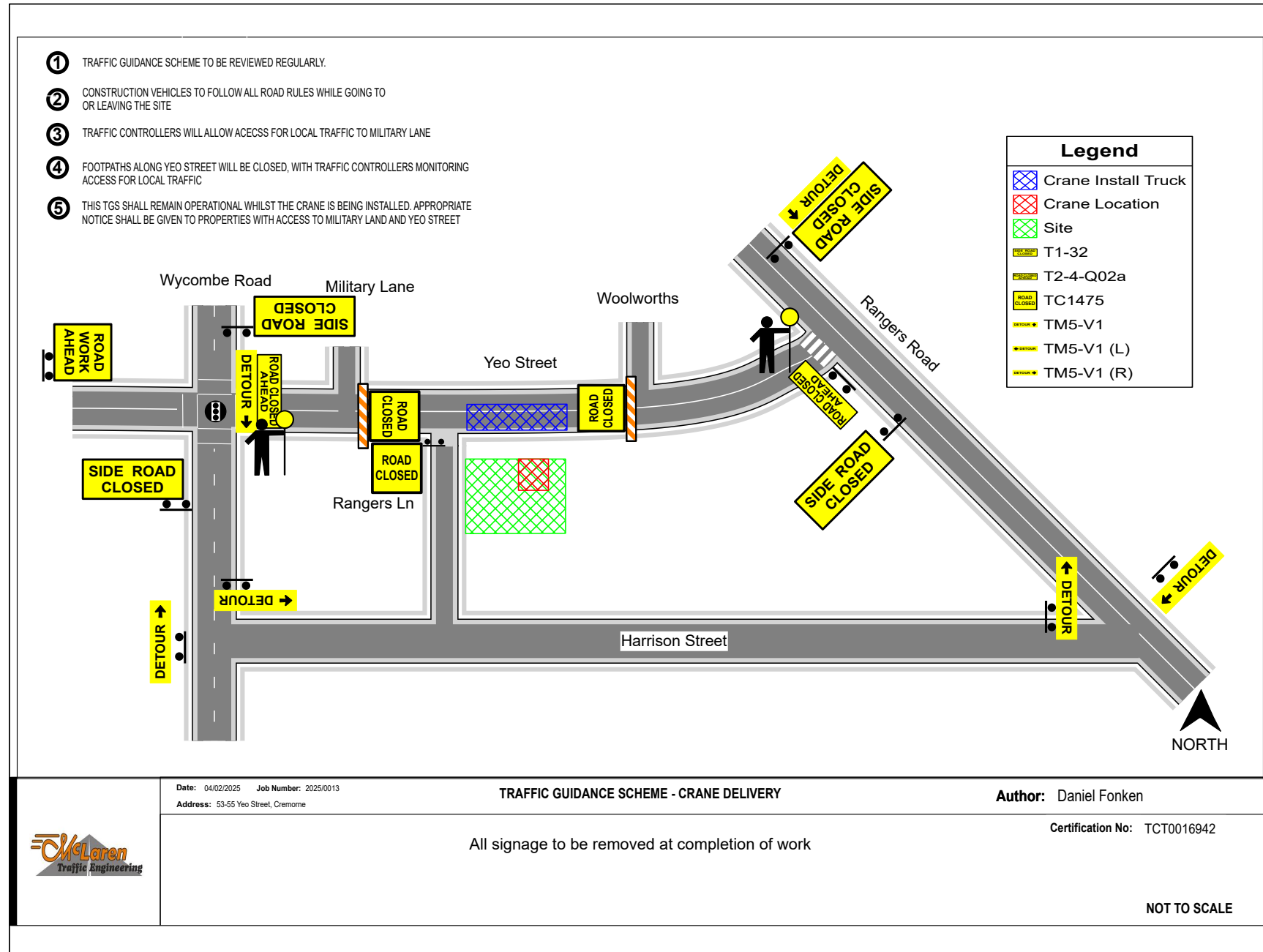

Proposal

451 Miller Street Cammeray NSW
Proposed Works Zone

**LEGEND:** **Existing**

"1P 10am-6pm
Mon-Fri
8.30am-12.30pm
Sat",
"Clearway 6am-
10am Mon-Fri"

Proposal

"Works Zone
10am-5pm Mon-Fri
8am-1pm Sat",
"Clearway 6am-
10am Mon-Fri"

Proposal



Kareela Road, Cremorne Point
Proposal to Install Accessible Parking



Existing

- No Stopping
- Unrestricted Parking

Proposed

- Accessible Parking
- No Parking



Proposal Spofforth Lane at Florence Lane, Cremorne – Proposed “No Stopping” Signage



Existing

— “No Stopping” Restriction per Road Rules 2014

Proposed

□ Installation of “No Stopping” Signage

5.2. West Street, North Sydney - Parking Restriction Change

AUTHOR	Jasmine Wong, Transport Engineer
ENDORSED BY	Gary Parsons, Director Open Space and Infrastructure
ATTACHMENTS	1. West Street, North Sydney - Plan [5.2.1 - 1 page]
CSP LINK	2. Our Built Infrastructure 2.4 Efficient traffic mobility and parking

PURPOSE:

The purpose of this report is to seek the committee's endorsement to change unrestricted parking to time restricted parking with permit holders excepted on West Street between Ridge Street and Myrtle Street in North Sydney.

EXECUTIVE SUMMARY:

- To address community concerns about limited parking availability and low turnover of spaces along West Street, Council undertook community consultation to convert unrestricted parking to "2P 8:30am-6pm Mon-Fri Permit Holders Excepted Area 21" between Ridge Street and Myrtle Street.
- The proposal aims to make short term parking more accessible by increasing turnover and to support a vibrant urban environment, in line with Council's Community Strategic Plan.
- On 10 February 2025, Council adopted its Integrated Transport Strategy which includes a Strategic Direction to ensure a fair allocation of assets, parking and road space to promote sustainable travel and prioritise access for those who need it most. The proposal would align with this strategic direction by improving parking availability during business hours allowing residents and visitors will have greater opportunity to park in the area.
- Occupancy surveys undertaken for the parking indicate between 95% and 100% of spaces are occupied during both daytime and evening hours indicating that drivers would be currently highly unlikely to find an available parking space to park at any time. This supports community concerns that the high occupancy and limited turnover severely limit access to the parking spaces.
- The responses to the consultation show 22% support from the submissions received for the proposal with 78% opposed to the proposal. Reasons for the community's support consisted of improved parking turnover, better access for short-term users, and improved access to local businesses and amenities.

- Objections to the proposal predominantly related to the limited parking availability. These responses included concerns about the loss of long-term parking and concerns about limited parking alternatives for residents who are not eligible for parking permits and do not have access to off-street parking.
- Access to parking is the primary concern outlined in submissions for and against the proposal. The occupancy surveys support the concern that drivers are currently highly unlikely to find an available parking space. Parking demand is also expected to increase with development of the Marist College, new Metro Station and continuation of the West Street cycleway.
- While the consultation received more opposition than support, it is considered that the proposal would help address community concerns about limited turnover and increase access to parking by ensuring that drivers without a resident parking permit are allowed to park in the area for up to two hours during the day.

RECOMMENDATION:

1. THAT the Committee endorse the proposed conversion of unrestricted parking to “2P 8:30am-6pm Mon-Fri, Permit Holders Excepted Area 21” at the following locations:

- Between points 20 metres and 44 metres (4 car spaces) on the western side of West Street, north of Ridge Street, North Sydney.
- Between points 26 metres and 140 metres (19 car spaces) on the eastern side of West Street, north of Ridge Street, North Sydney.

Background

In response to community concerns about limited turnover and the lack of availability of parking and in unrestricted parking spaces in West Street, North Sydney between Ridge Street and Mrytle Street, Council undertook occupancy surveys on 16 July 2024. The surveys showed that at least 95% of the kerbside parking was occupied during the daytime and evening.

Subsequent surveys undertaken on 28 February 2025 and 1 April 2025 recorded a parking occupancy of 100% during the daytime and evening. This supports community concerns that the high occupancy and limited turnover severely limit access to the parking spaces.

Between 9 July 2024 and 10 September 2024, Council undertook community consultation on a proposal to convert two sections of unrestricted parking on West Street to "1P 8:30am-6pm Mon-Fri Permit Holders Excepted Area 21". In response to the consultation, Council received 45% support of the change with 65% opposed to the change.

The consultation identified that 1-hour parking was considered a significant constraint on the time people could spend parking in the area and as a result and so, it was identified that a proposed "2P 8:30am-6pm Mon-Fri Permit Holders Excepted Area 21" restriction would better align with community needs based on submissions received.

Report

Based on the community feedback on the proposal to convert unrestricted parking to 1-hour parking on West Street, North Sydney and to address the limited availability and turnover of parking, a revised proposal for "2P 8:30am-6pm Mon-Fri Permit Holders Excepted Area 21" was consulted between 10 December 2024 and 4 March 2025.

The proposed "2P 8:30am-6pm Mon-Fri Permit Holders Excepted Area 21" restriction would limit any vehicle without a valid parking permit to parking for a maximum of two hours between 8:30am and 6pm Monday to Friday.

The parking spaces would return to unrestricted controls in the evenings and weekends. The change would encourage a turnover of vehicles and improve the likelihood of an available parking space while still allowing for drivers to park for longer term in the evening and weekends.

The proposal would align with Councils adopted Integrated Transport Strategy which includes a Strategic Direction to ensure a fair allocation of assets, parking and road space to promote sustainable travel and prioritise access for those who need it most. The proposal would align with this strategic direction by improving parking availability during business hours allowing residents and visitors will have greater opportunity to park in the area.

Public Consultation

Community consultation of the revised proposal, “2P 8:30am-6pm Mon-Fri Permit Holders Excepted Area 21”, took place between 10 December 2024 and 4 March 2025. A total of 228 letters were delivered to properties located in the vicinity of the proposal. Further, an online survey was available through Council’s “Have Your Say” webpage.

Respondents to community consultation are not considered as votes, but the information is used to assist in determining key concerns, reasons and level of support for a proposal.

In response, a total of twenty-three submissions were received, including five submissions from outside the survey area. Results of the survey are shown in the table below:

I support the proposed “2P 8:30am-6pm Mon-Fri Permit Holders Excepted Area 21” restriction on West Street, North Sydney	Submissions				Total
	No		Yes		
	Qty	%	Qty	%	
Within Survey Area	13	72%	5	28%	18
Outside Survey Area	5	100%	0	0%	5
Total	18	78%	5	22%	23

The results indicate 22% support from the submissions received for the proposal with 78% opposed to the proposal. Reasons for the community’s support consisted of improved parking turnover, better access for short-term users, and improved access to local businesses and amenities.

Objections to the proposal predominantly related to the limited parking availability. This included concerns about the loss of long-term parking and concerns about limited parking alternatives for residents who are not eligible for parking permits and do not have access to off-street parking.

Council investigations into parking controls show that the implementation of timed restrictions in unrestricted parking areas result in greater turnover of parking spaces and as a result, increase the opportunity for drivers to park in the area, particularly in areas where vehicles being parked for long periods of time limit the availability of parking.

Parking availability is a concern outlined in submissions for and against the proposal. The occupancy surveys support the concern that drivers are currently highly unlikely to find an available parking space. Parking demand is also expected to increase with development of the Marist College, new Metro Station and continuation of the West Street cycleway. Given these factors, it is considered that the proposal would help address community concerns about limited turnover and increase access to parking by ensuring that drivers parking for longer term without a permit would be required to turnover to allow other road users an opportunity to park.

Submissions Received

Council consolidates community feedback into major themes as opposed to including every individual submission. Responses to the submissions are also outlined in the table below and considers the amended proposal.

Theme	Submission	Response
Lack of Unrestricted Parking	<ul style="list-style-type: none"> • We need areas of unrestricted parking nearby. It should stay unrestricted. • There is very little unrestricted parking in the local area, please leave the current spaces as is. 	<p>Parking occupancy surveys have shown that the existing unrestricted spaces are operating near or at full capacity, making it difficult to access an available space.</p> <p>The proposal aims to improve turnover and access for a broader range of users, including residents, visitors, and local business patrons.</p>
Impacts on Residents	<ul style="list-style-type: none"> • Nearby residents already have off-street parking, which they should use instead of occupying on-street spaces. • With the increase in council rates, this is another burden that would cost residents more money in having to rent parking spaces for their vehicles. • I don't have off-street parking. We rely on this space when working from home. • How can someone working from home spend valuable time moving their car every two hours? 	<p>Council acknowledges the concerns raised by residents without off-street parking. However, it is important to note that on-street parking may be utilised by both residents and visitors.</p> <p>Parking occupancy surveys indicate it is currently difficult to find an available space. The unrestricted parking has resulted in the spaces being occupied for long periods. This limits the opportunity for any driver to park. The proposed changes would improve parking turnover and access to parking.</p> <p>Where a resident has no available off-street parking they may be able to obtain a permit, allowing eligible residents in Area 21 to park for longer durations.</p>
Public Transport	<ul style="list-style-type: none"> • There is a distinct lack of parking for residents who would like to leave their vehicle at home and utilise public transport. • Penalising residents for using the Metro and other means of transport would be counterproductive. 	<p>Council recognises the importance of access to the Metro.</p> <p>However, the aim of the proposal is not to directly increase public transport uptake but to address the limited turnover from long stay vehicles and resulting limited available on-street space.</p>

Previous Consultation	<ul style="list-style-type: none"> • Leave it as unrestricted as voted before. • This is absolutely despicable and shows no regard for what residents have already voted to keep unrestricted. • 60% of respondents objected to Council's proposal to change from Unrestricted to 1-hour, and now Council is trying to circumvent that outcome by changing it to 2 hours. 	<p>It is acknowledged that the previous proposal to introduce 1-hour parking was not supported by the majority of respondents.</p> <p>In response, the proposal has been revised to a 2-hour limit with permit holder exemptions to better balance the needs of residents, visitors, and local businesses.</p> <p>This revised proposal seeks to address ongoing concerns about low parking turnover, while still allowing eligible residents to park for longer durations.</p>
Businesses	<ul style="list-style-type: none"> • As our staff start the business from 6am, it is very hard to arrive by public transport. We just need one car park for the shop to make it easy to operate. 	<p>Council recognises the importance of supporting local businesses. However, on-street car spaces cannot be dedicated to specific businesses.</p> <p>Nonetheless, the proposed parking changes aim to improve turnover, which can benefit businesses by increasing access to parking for customers. Commuters who cannot find an available parking space on street can make use of discounted and available parking in Councils nearby parking in Ridge Street and West Street car parks.</p>
Opposition to Parking Meters	<ul style="list-style-type: none"> • Please do not add any more parking meters around West Street. This is not a commercial area and residents and visitors should not be paying the council to park here. 	<p>The proposal does not include the installation of parking meters.</p>
Support for Proposed Changes	<ul style="list-style-type: none"> • At the moment, it is impossible to park in this area. Cars are regularly parked by non-residents • Unrestricted parking does not free up parking spaces but instead achieves the opposite—cars are left for days, weeks, months, even years. • There is a very high demand for short-term parking due to the proximity to the Metro station and to local cafes and businesses. The area adjoins Ridge Street, 	<p>Council acknowledges the high demand for parking in this area and the challenges posed by long-term vehicle storage.</p> <p>The proposed time restrictions would help to discourage vehicle “dumping”, improve turnover, and make parking more accessible for short-term users, including those getting dropped off to utilise public transport or accessing businesses.</p>

	which has metered parking, highlighting the precious nature of the resource.	This approach supports better use of limited kerbside space in a high-demand location and help support a more vibrant urban environment, in line with Council's Community Strategic Plan.
Other Concerns	<ul style="list-style-type: none"> • My main concern is exiting our building (28 West St) via the ramp—visibility is virtually impossible. My proposal would be to have NO parking at all in the two spaces at the top of our ramp to increase our visibility and reduce the risks. Often there may be a van/truck/4x4 parked there making it impossible to see what traffic is coming. • Please keep the 1/2 hour parking area in front of No 60-64 West St, North Sydney as it is. 	<p>The two spaces fall outside of the scope of the proposal. Nonetheless, given parking on-street adjacent to driveways is permissible under current legislation, the removal of these spaces is unlikely to be supportable.</p> <p>The 1/2P parking in front of 60-64 West St, North Sydney will remain unchanged.</p>

Conclusion

Parking availability is a concern outlined in submissions for and against the proposal. The occupancy surveys support the concern that drivers are currently highly unlikely to find an available parking space. Parking demand is also expected to increase with the development of the nearby Marist College, the new Metro Station nearby and the continuation of the West Street cycleway.

Given these factors, while the consultation received more submission in opposition than in support, it is considered that the proposal would help address community concerns about limited turnover and increase access to parking. As such, it is recommended that the Committee endorse the proposed "2P 8:30am-6pm Mon-Fri Permit Holders Excepted Area 21" on West Street between Ridge Street and Mrytle Street.

Financial/Resource Implications

The cost of upgrading proposed changes to parking restrictions will be covered by Council's Operating Expenditure budget.



Proposal

West Street, North Sydney – Proposed Parking Restriction



Existing

- ■ ■ ■ ■ "No Stopping"
- ■ ■ ■ ■ "Unrestricted"
- ■ ■ ■ ■ "1P 8:30am-6pm Mon-Fri Permit Holders Excepted Area 21"
- ■ ■ ■ ■ "No Parking Authorised Car Share Vehicles Excepted Area 100"

Proposed

- "2P 8:30am-6pm Mon-Fri Permit Holders Excepted Area 21"

6. Informal Items for Consideration

Nil

7. Local Development Advisory Committee Items for Consideration

Nil

8. Closure